

**POWER APPLICATIONS  
COMMON MODE CHOKES**

- **COMPACT SIZE, YET HIGH POWERED**
- **2500 VRMS ISOLATION STANDARD**
- **UL94VO**
- **COMPLIES WITH VDE 565-2**
- **NOMINAL VOLTAGE: 250VAC**
- **OTHER VALUES AND SIZES READILY AVAILABLE**

**ELECTRICAL SPECIFICATIONS @ 25°C**

<b>PART NUMBER</b>	<b>INDUCTANCE (mh ±30%)</b>	<b>CURRENT (AAC)</b>	<b>DCR (OHMS ±20%)</b>	<b>RESONANT FREQ. (kHz)</b>
XF0033-V01	3	1.50	0.17	800
XF0073-V01	7	1.20	0.30	400
XF0103-V01	10	0.70	0.50	350
XF0153-V01	15	0.50	0.80	300
XF0183-V01	18	0.45	1.00	200
XF0303-V01	30	0.40	2.00	180
XF0503-V01	50	0.30	2.30	100
XF0033-H02	3	1.50	0.17	800
XF0073-H02	7	1.20	0.30	400
XF0103-H02	10	0.70	0.70	350
XF0153-H02	15	0.50	0.80	300
XF0183-H02	18	0.45	1.00	200
XF0303-H02	30	0.40	2.00	180
XF0503-H02	50	0.30	2.30	100

## 1. Mechanical Dimensions:

### 01 Package

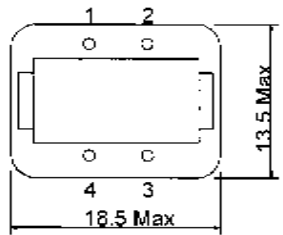
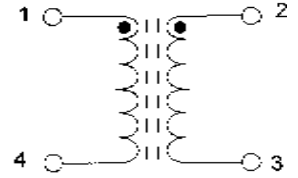
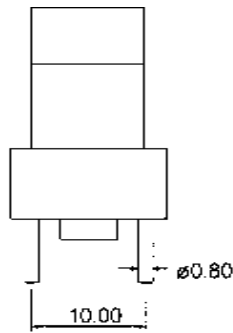
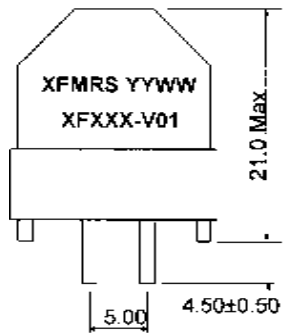

(BOTTOM VIEW)

### 02 Package

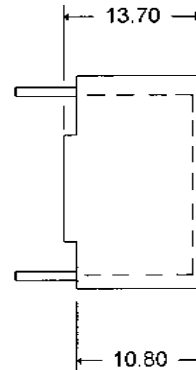
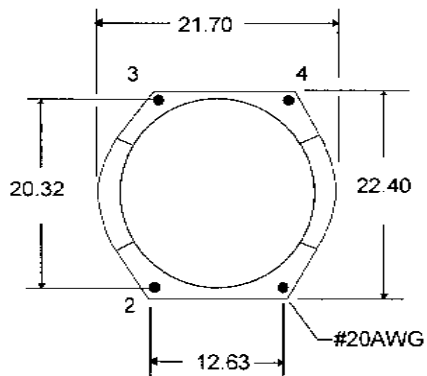

## POWER LINE CHOKES COMMON MODE CHOKES

THESE SMALL POWER LINE CHOKES CAN BE USED TO MINIMIZE EMI RADIATED NOISE IN THE COMMON MODE ON ALL POWER APPLICATIONS. THE XFMRS GROUP OFFERS A WIDE VARIETY OF INDUCTANCE AND RATED CURRENTS TO PROVIDE FULL COVERAGE OF YOUR POWER REQUIREMENTS.

- 2000 VOLTS AC FOR 60 SECONDS ISOLATION VOLTAGE
- 250 VOLTS AC/DC RATED VOLTAGE
- INSULATION RESISTANCE IS 100 Mohms MINIMUM AT 500 VDC
- CUSTOM VARIATIONS WELCOME AT NO EXTRA CHARGE

### ELECTRICAL SPECIFICATIONS @ 25°C

PART NUMBER	RATED CURRENT I/LINE	INDUCTANCE OCL (mH) MIN	DCR (OHMS/LINE) MAX
XF0303-00U	0.40	30.0	2.80
XF0203-00U	0.50	20.0	1.60
XF0103-00U	0.60	10.0	1.20
XF0083-00U	0.80	8.0	0.80
XF0063-00U	0.80	6.0	0.70
XF0043-00U	1.00	4.0	0.40
XF0033-00U	0.75	3.0	1.00
XF0023-00U	1.20	2.0	0.30

### SCHEMATIC

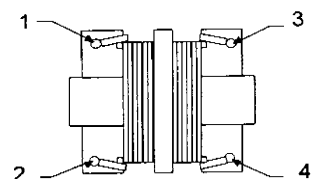
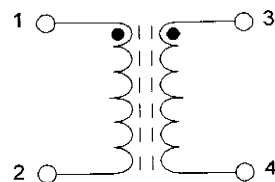

### MECHANICALS

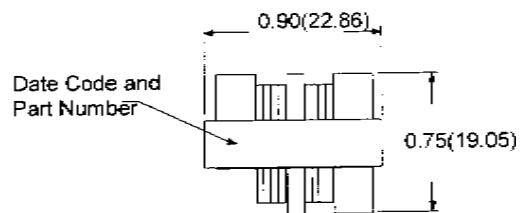
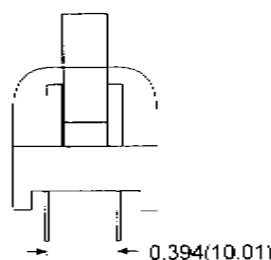
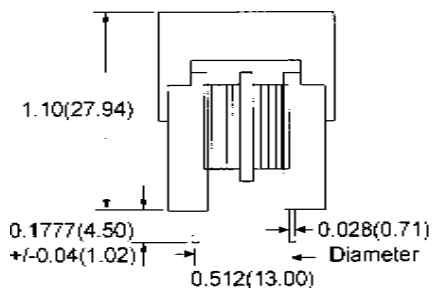

Dimensions are in inches(mm)  
Dimension tolerance is equal to  
+/-0.02(0.51) unless otherwise stated.

## MECHANICALS

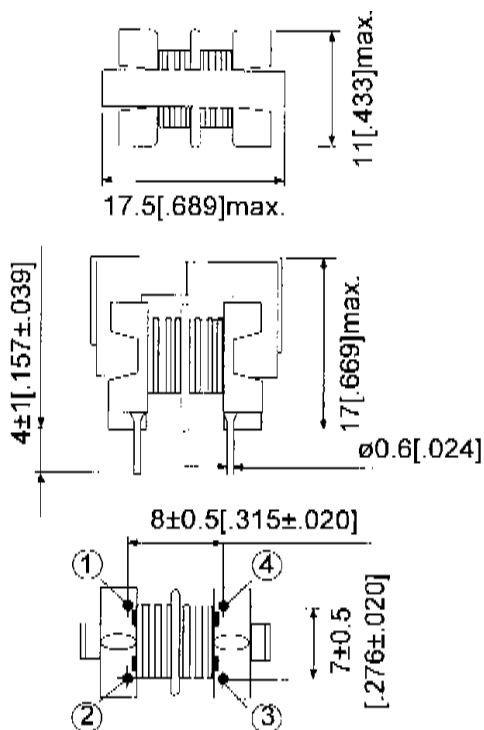

## SCHEMATIC

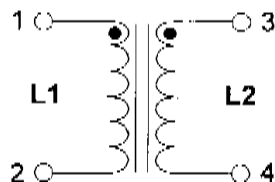

PART NUMBER	INDUCTANCE (mH) MIN.	DC RESISTANCE (OHMS) MAX.	RATED CURRENT (Aac)
XF0153-00U2	15	5	0.15
XF0073-00U2	7	2.5	0.30

Dimensions are in mm(inches)

## 1. Mechanical Dimensions:

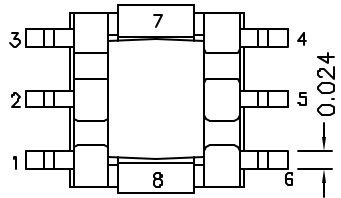

(BOTTOM VIEW)

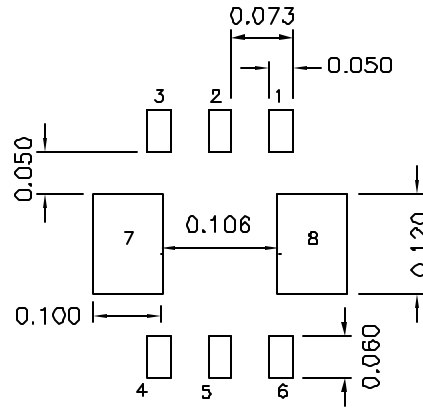

SUGGESTED PCB LAYOUT

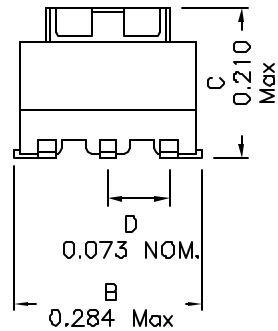
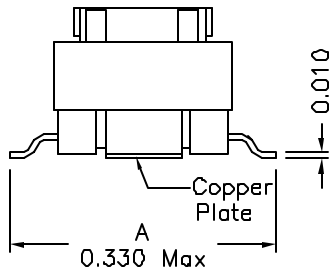

White dot for indicates Pin #1

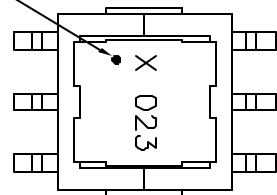

(TOP VIEW)

## 2. Schematic:

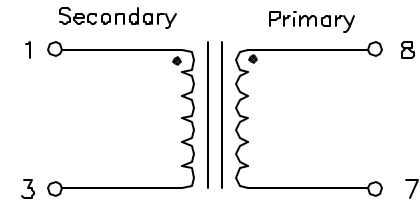

## 3. Electrical Specifications: @25°C

OCL: Pins 1-3 1800uH Min @100KHz 0.1V

Q: Pins 1-3 40 Min @100KHz 0.1V

DCR: Pins 1-3 5.50 Ohms Max

Hipot: 1000Vac, Pri to Sec

Primary Rating: 20Arms @100KHz and above

Terminating Resistor: 16.67 Ohms for 1Vout

Turns Ratio: (1-3):(8-7)=100:1±5%

### Notes:

1. Solderability: Leads shall meet MIL-STD-202G, Method 208H for solderability.
2. Flammability: UL94V-0
3. ASTM oxygen index: > 28%
4. Insulation System: Class F 155°C. UL file E151556
5. Operating Temperature Range: All listed parameters are to be within tolerance from -40°C to +105°C
6. Storage Temperature Range: -55°C to +125°C
7. Aqueous wash compatible
8. SMD Lead Coplanarity: ±0.004"(0.102mm)
9. Electrical and mechanical specifications 100% tested
10. RoHS Compliant Component

DOC REV: A/14

<b>XFMRS Inc</b> www.XFMRS.com	Model: Current Sense Xfmr		
Unless Otherwise Specified TOLERANCES: .xxx ±0.010 Dimensions in INCH	P/N: XF0023-EE5CS		REV. A
	DWN.	Feng	Oct-26-11
SHEET 1 OF 1	CHK.	YK Liao	Oct-26-11
	APP.	JOe Huff	Oct-26-11

## 1. Mechanical Dimensions:

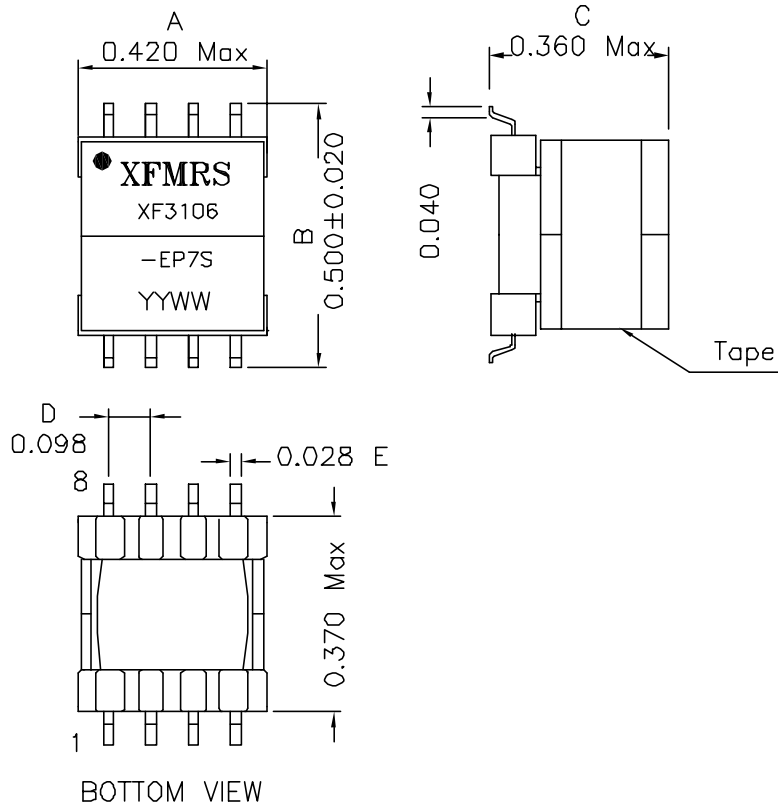

### Notes:

- Solderability: Leads shall meet MIL-STD-202, Method 208D for solderability.
- Flammability: UL94V-0
- ASTM oxygen index: > 28%
- Insulation System: Class F 155°C. UL file E151556
- Operating Temperature Range: All listed parameters are to be within tolerance from -40°C to +85°C
- Storage Temperature Range: -55°C to +125°C
- Aqueous wash compatible
- SMD Lead Coplanarity: ±0.004" (0.102mm)
- Moisture Sensitivity: Level 3
- Electrical and mechanical specifications 100% tested
- RoHS Compliant Component

DOC. REV: A/2

## 2. Schematic:

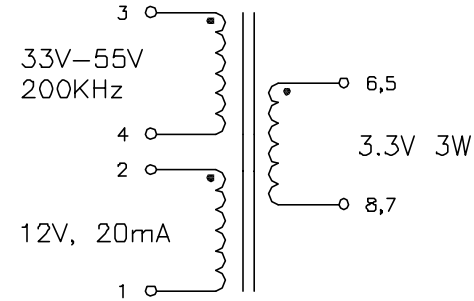

## 3. Electrical Specifications:

OCL: Pins 3-4 310uH ± 10% @ 10KHz, 0.1V

LL: Pins 3-4 5uH Max @ 100KHz, 0.1V Short P6,5,8,7

DCR: P3-4 1.60 Ohms Max

DCR: P2-1 2.6 Ohms Max

DCR: P6,5-8-7 0.045 Ohms Max

Turns Ratio: 3-4:2-1:6,5-8,7 = 1:0.682:0.182

Isolation: 1500Vac, Pri. to Sec.

<b>XFMRS Inc</b> www.XFMRS.com	Title: TRANSFORMER	
UNLESS OTHERWISE SPECIFIED TOLERANCES: .xxx ±0.010 Dimensions in INCH	P/N: XF3106-EP7S	REV. A
	DWN. 廖玉坤	Mar-01-05
Scale 1.5:1 SHT 1 OF 1	CHK. 李清儿	Mar-01-05
	APP. BW	Mar-01-05

**PROPRIETARY** Document is the property of XFMRS Group & is not allowed to be duplicated without authorization.

## 1. Mechanical Dimensions:

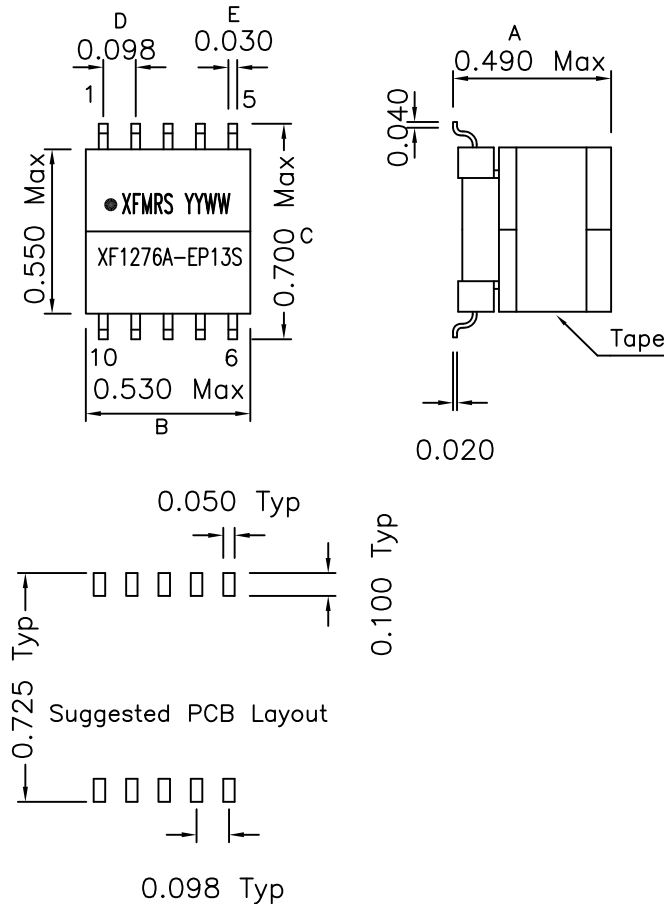

## 2. Schematic:

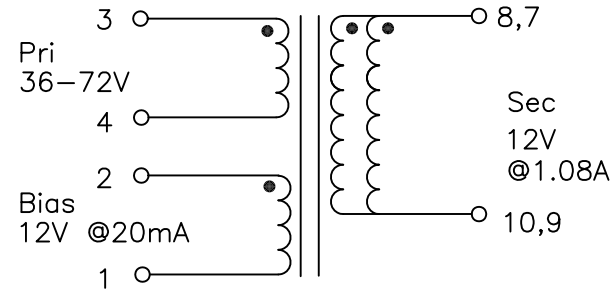

## 3. Electrical Specifications:

- OCL: Pins 3-4 127uH±10% @250KHz 0.2V  
 Pins 3-4 114.3uH Min @250KHz 0.2V, 1Adc
- Q: 3-4 100 Min @250KHz 0.2V
- LL: Pins 3-4 0.650uH Max @250KHz 0.1V, Short All Else
- DCR: Pins 3-4 0.199 Ohms Max  
 Pins 2-1 0.308 Ohms Max  
 Pins 8,7-10,9 0.129 Ohms Max
- Turns Ratio: Pins (3-4):(2-1):(8-10):(7-9)= 1:0.5:0.5:0.5
- Hipot: 1500Vrms Pri & Bias to Sec

### Notes:

1. Solderability: Leads shall meet MIL-STD-202G, Method 208H for solderability.
2. Flammability: UL94V-0
3. ASTM oxygen index: > 28%
4. Insulation System: Class F 155°C. UL file E151556
5. Operating Temperature Range: All listed parameters are to be within tolerance from -40°C to +85°C
6. Storage Temperature Range: -55°C to +125°C
7. Aqueous wash compatible
8. SMD Lead Coplanarity: ±0.004"(0.102mm)
9. Electrical and mechanical specifications 100% tested
10. RoHS Compliant Component

DOC. REV: A/4

<b>XFMR Inc</b> www.XFMR.com		Title: <b>PoE Transformer</b>	
UNLESS OTHERWISE SPECIFIED TOLERANCES: .xxx ±0.010 Dimensions in INCH		P/N:XF1276A-EP13S	REV. A
		DWN.	Yuan
		CHK.	YK Liao
SHEET 1 OF 1		APP.	BSJ
			Sep-11-12
			Sep-11-12
			Sep-11-12

## 1. Mechanical Dimensions:

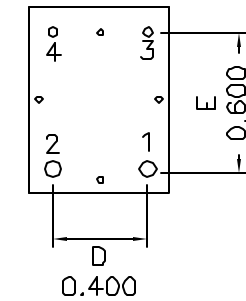
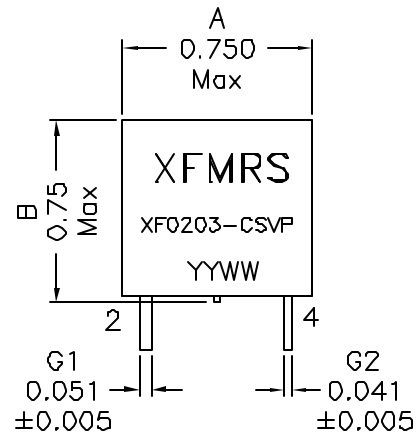

Bottom View

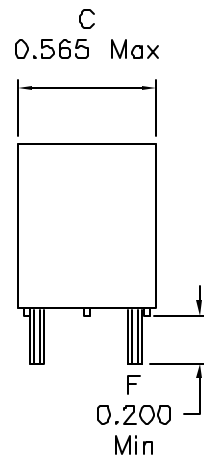

### Notes:

1. Solderability: Leads shall meet MIL-STD-202G, Method 208H for solderability.
2. Flammability: UL94V-0
3. ASTM oxygen index: > 28%
4. Insulation System: Class F 150°C. UL file E151556
5. Operating Temperature Range: All listed parameters are to be within tolerance from -40°C to +85°C
6. Storage Temperature Range: -55°C to +125°C
7. Aqueous wash compatible
8. Electrical and mechanical specifications 100% tested
9. RoHS Compliant Component

DOC. REV A/3

## 2. Schematic:

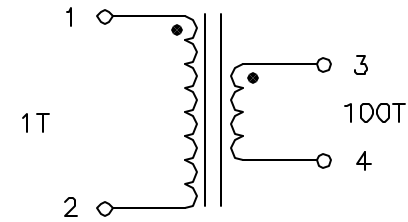

## 3. Electrical Specifications: @25°C

OCL: Pins 3-4 20mH Min @1.0KHz,1.0V

Q: Pins 3-4 4.0 Min @1.0KHz,1.0V

DCR: P3-4 1.4 Ohms Max

Sensed Current: 37A Max

Sensitivity:  $V_{out}=1V$  ;  $I_{in}=1A$

Terminating Resistor: 56 Ohm

Turns: 100

Isolation: 3750Vrms Pri to Sec

**XFMRS Inc.**  
www.XFMRS.com

Title:  
Current Sense Transformer

UNLESS OTHERWISE SPECIFIED  
TOLERANCES:  
.xxx ±0.010

P/N: XF0203-CSVP REV. A

Dimensions in INCH

DWN. Xianyi May-27-09

SHEET 1 OF 1

CHK. YK Liao May-27-09

APP. Joe Huff May-27-09

**PROPRIETARY** Document is the property of XFMRS Group & is not allowed to be duplicated without authorization.